

Slate tile system

Installation guide summary

IMPORTANT: FOLLOW STEPS CONTAINED IN THE PRESENT GUIDE FOR WARRANTY TO BE HONOURED.

* IMPORTANT

- NOTE 1 DURING INSTALLATION OF NOVIK SLATE TILE, IT IS STRONGLY ADVISED TO USE ONLY RECOMMENDED MATERIALS AND/OR TOOLS. APPROPRIATE SAFETY MEASURES SHOULD BE APPLIED TO PREVENT INCIDENTS THAT MAY CAUSE INJURIES FOR WHICH MANUFACTURER SHALL NOT BE HELD LIABLE.
- NOTE 2 **TILE IS NOT IMPERMEABLE. IMPERMEABILITY (WATERPROOFNESS) IS ENSURED BY THE MEMBRANE** (IT IS IMPORTANT TO FOLLOW ALL INSTRUCTIONS OF MEMBRANE MANUFACTURER). IN CASE OF WATER INFILTRATION UNDER PANELS, TILES ARE DESIGNED TO PERMIT WATER TO DRAIN OFF.
- NOTE 3 AT THE TIME PARTS ARE NAILED, **LEAVE 1/32" (0,08cm)** SPACE BETWEEN THE HEAD OF THE NAIL AND THE PART. NAIL THE LAST UPPER HOLE ONLY AFTER HAVING OVERLAPPED THE PART FOLLOWING IT.
- NOTE 4 **LEAVE A 1/4" (0,64cm)** SPACE BETWEEN THE PANEL AND THE INSIDE WALL OF THE UNIVERSAL CHANNEL, TO ALLOW FOR EXPANSION AND CONTRACTION OF THE PART.
- NOTE 5A DURING VERTICAL ASSEMBLY OF PANELS, DO NOT APPLY PRESSURE TO POSITIONING STOPS. IF RESISTANCE IS FELT, DO NOT FORCE INSERTION OF PART. **USE REFERENCE MARKS « J L »** TO CONFIRM CORRECT POSITIONING OF PANELS (SEE DRAWINGS OF STEPS 4A AND 4B).
- NOTE 5B HORIZONTAL ASSEMBLY: IF RESISTANCE IS FELT, DO NOT FORCE INSERTION OF PART. USE THE TWO LOCATING LINES TO ENSURE CORRECT POSITIONING. (SEE STEP 4B).
- NOTE 6 **USE WATERPROOF, SELF-SEALING / SELF-ADHERING / SELF-HEALING MEMBRANE (MEETING THE 1970 ATSM STANDARD) OVER ENTIRE SURFACE OF ROOF. THE MEMBRANE USED MUST MEET THE REQUIRED CHARACTERISTICS OR WARRANTY IS NULL AND VOID.**
- NOTE 7 INSTALL THE MEMBRANE FOLLOWING MANUFACTURER'S SPECIFICATIONS.
- NOTE 8 USE 1-1/4" (3,2cm) HOT GALVANIZED ROOFING NAILS WITH A HEAD OF 0.4" (1cm) IN DIAMETER AND A BODY OF 0.150" (0,38cm) OF DIAMETER.
- NOTE 9 WHEN INSTALLED AT OUTDOOR TEMPERATURES UNDER 40° F (5° C) – ADJUST PANEL TO TEMPERATURE LINE INDICATED (SEE INDICATIONS AT UPPER EDGE OF START STRIPS OR OF PANELS).
- NOTE 10 THE INSTALLATION MUST BE DONE ON A ROOF WITH A **MINIMUM PITCH OF 3 : 12.**
- NOTE 11 KEEP PRECIOUSLY THE R-E-L NUMBER OF YOUR PRODUCTS (EX: REL-123456) FOR FUTURE REFERENCES.
- NOTE 12 **WARNING, SNOW AND ICE WILL NOT STICK ONTO NOVIK CLAY TILE ROOFING SYSTEM. IT IS STRONGLY RECOMMENDED TO INSTALL SNOW GUARDS WHERE SNOW AND / OR ICE FALL COULD CAUSE INJURIES AND / OR DAMAGES**

STEP 1 WATERPROOF MEMBRANE

SELF-SEALING / SELF-ADHERING / SELF-HEALING / CLASS C FIRE RESISTANCE

WATERPROOFING THE ROOF IS ENSURED BY THE MEMBRANE (E.G. CHIMNEY, PIPING, ETC.) THE MEMBRANE MUST BE INSTAL ACORDING TO THE MANUFACTURER'S INSTRUCTIONS.

THE MEMBRANE ENSURES WATERPROOFNESS OF ROOF.

STEP 2 UNIVERSAL SLATE MOULDING

DETAILS / DIMENSIONS / INSTALLATION

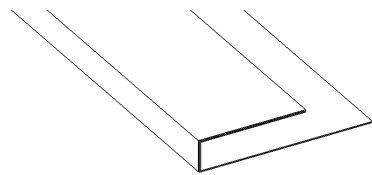

MATERIAL: ALUMINUM
THICKNESS: 0.0185" (0,047cm)
DIMENSIONS: 1.88" (4,78cm) X 0.625" (1,59cm) X 3.00" (7,62cm)
LENGTH: 9.84' (3m)

A INSTALLING FLASHING ON SLOPE

UNIVERSAL SLATE CHANNEL

- A: MEMBRANE
B: DRIP EDGE FLASHING
C: PLYWOOD
D: UNIVERSAL SLATE CHANNEL
E: NOVIK ROOFING PANEL
F: STANDARD V-SHAPED METAL FLASHING
G: STANDARD L-SHAPED FLASHING
H: WALL

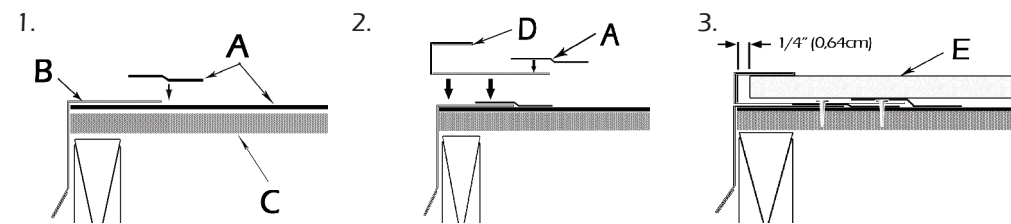

1. INSTALL THE RECOMMENDED MEMBRANE (NOTES 6-7). INSTALL DRIP EDGE FLASHING. COVER END OF DRIP EDGE WITH A MEMBRANE STRAP (NOTE 8).
2. NEXT INSTALL THE UNIVERSAL CHANNEL. AND COVER THE END OF THE CHANNEL WITH A MEMBRANE STRAP (NOTE 8).
3. THE ROOFING SYSTEM WILL BE ENGAGED INTO THE UNIVERSAL CHANNEL AT STEP 3 AND 4(NOTE 4).

B INSTALLING VALLEY CHANNEL FLASHING

UNIVERSAL SLATE CHANNEL

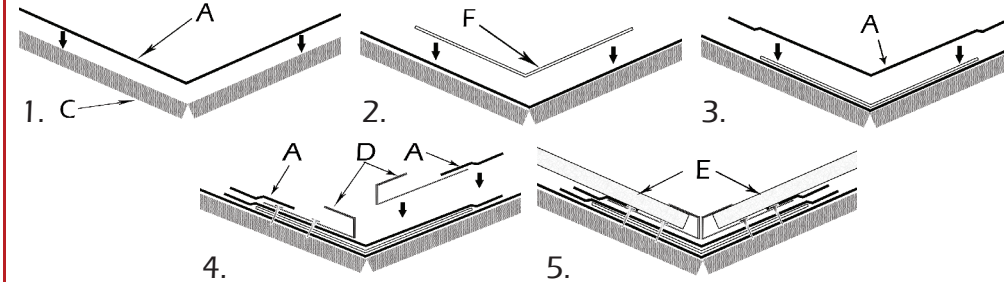

1. INSTALL RECOMMENDED MEMBRANE (NOTES 6-7).
2. INSTALL STANDARD V-SHAPED METAL FLASHING .
3. COVER ALL THE V-SHAPED FLASHING WITH MEMBRANE (NOTE 8).
4. NEXT INSTALL THE UNIVERSAL CHANNELS. AND COVER END OF UNIVERSAL CHANNELS WITH A MEMBRANE STRAP
5. THE ROOFING SYSTEM WILL BE ENGAGED INTO THE UNIVERSAL CHANNEL AT STEP 3 AND 4(NOTE 4).

C INSTALLING PARAPET FLASHING

UNIVERSAL SLATE CHANNEL

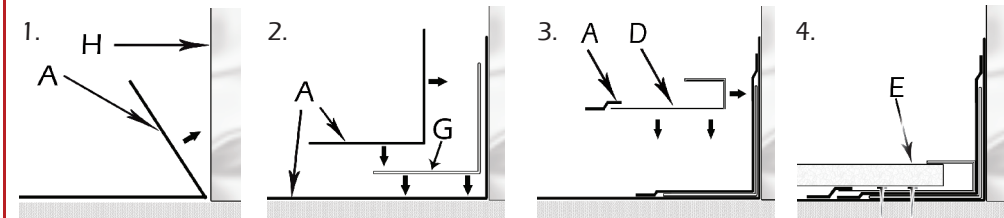

1. INSTALL MEMBRANE UP TO WALL EDGE CONTINUING 6" (15,24cm) UP THE WALL (NOTE 6 AND 7).
2. INSTALL STANDARD L-SHAPED FLASHING.
3. COVER ALL THE L-SHAPED FLASHING WITH MEMBRANE (NOTE 8).
4. INSTALL UNIVERSAL CHANNEL AND COVER HIS END WITH MEMBRANE STRAP (NOTE 8)
5. THE ROOFING SYSTEM WILL BE ENGAGED INTO THE UNIVERSAL CHANNEL AT STEP 3 AND 4(NOTE 4).

STEP 3 INSTALL STARTER STRIPS

INSTALLING SLATE SYSTEM

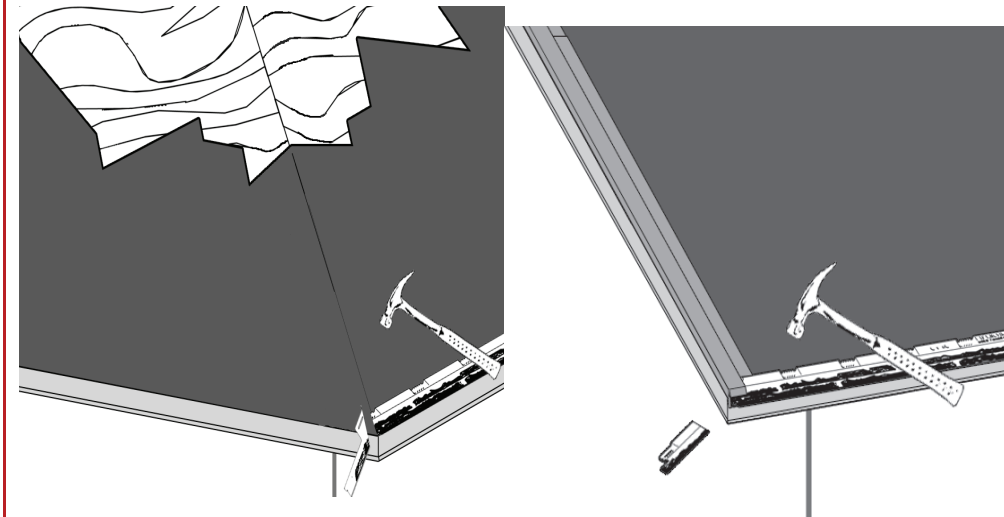

ROOF WITH 4 SLOPES
(ANGLED CUT)

ROOF WITH 2 SLOPES
(STRAIGHT CUT)

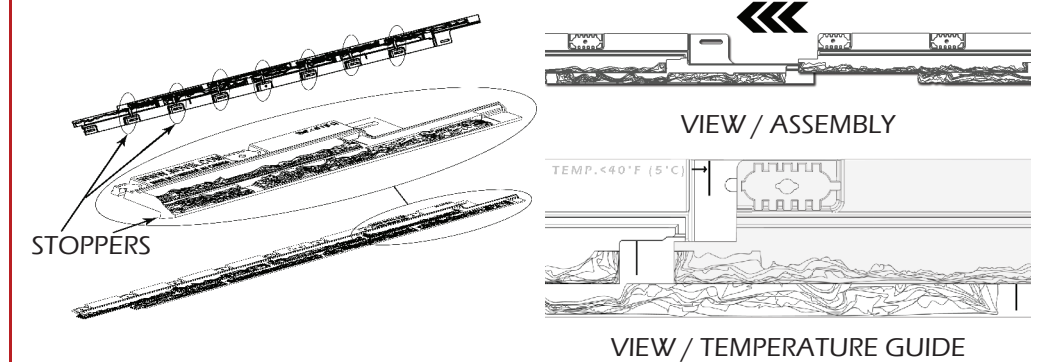

1. **STARTER STRIP MUST EXCEED EAVES BY 1/4" (0,64cm)** (NOTE 4).FOR THAT YOU MUST SLIDE THE STRIP UPWARD WHITOUT CRUSHING THE EXPANSION STOPS (NOTE 4 NOTE 5 AND SEE DRAWING ABOVE)
2. NAIL **CENTRAL** NAIL INTO THE STARTER STRIP.
3. NEXT NAIL OTHER HOLES – BUT NOT THE LAST ONE (NOTE 3).
4. **LINE UP THE STARTER STRIP WITH THE 2 GUIDE LINES. IF THE TEMPERATURE AT TIME OF INSTALLATION IS BELOW 40°F (5°C), LINE UP WITH THE LINE IDENTIFIED FOR THAT CONDITION. (SEE NOTE 9)**

STEP 4 INSTALLING PANELS

A) FIRST PANEL

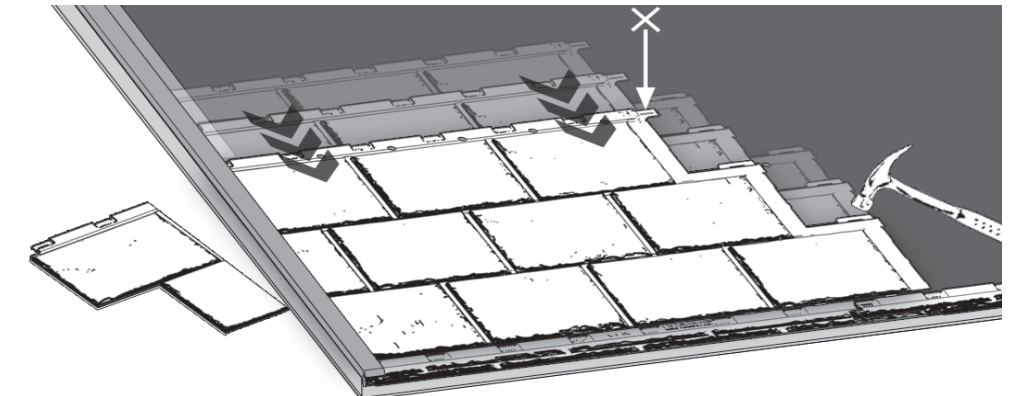

1. **ROOF WITH TWO SLOPES:** CUT THE PANEL AND SLIDE IT INTO THE UNIVERSAL CHANNEL (NOTE 4). GO TO POINT 3.
2. **ROOF WITH 4 SLOPES:** CUT PANEL 4" (10,16cm) FROM HIP IN INSTALLATION POSITION, FOLLOWING THE LINE OF THE HIP (SEE STEP 6).
3. SLIDE THE PANEL DOWNWARDS BUT MAKE SUR NOT TO BREAK THE EXPANSION STOPS (NOTE 5 AND SEE DRAWING BELOW).
4. LINE UP THE SLATE PATTERN (BETWEEN TILES) WITH THE STARTER STRIP.
5. FIRST NAIL **CENTRAL** NAIL INTO THE PANEL.
6. THEN NAIL THE OTHER HOLES – BUT NOT THE LAST NAIL (NOTE 3).

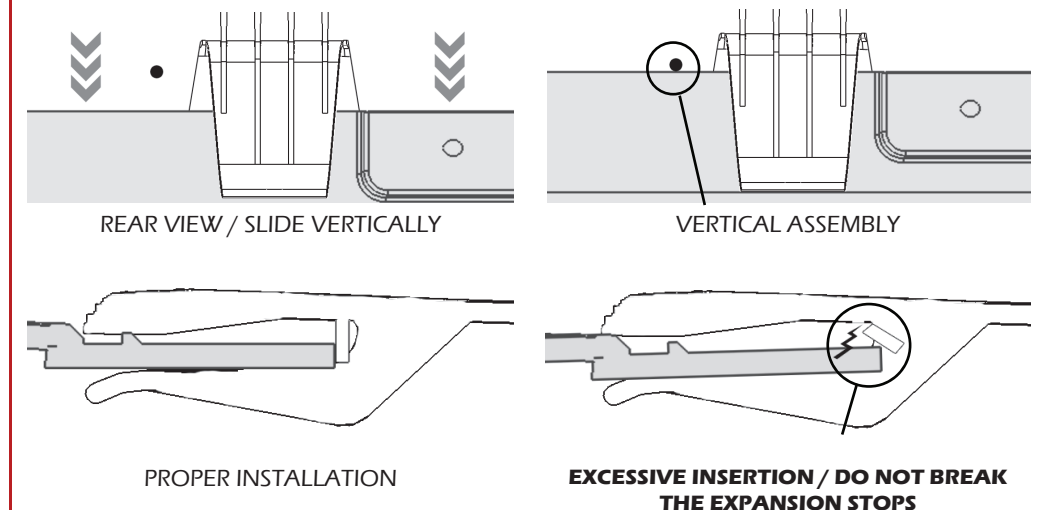

PROPER INSTALLATION

EXCESSIVE INSERTION / DO NOT BREAK THE EXPANSION STOPS

STEP 4 INSTALLING PANELS
B) PANELS FOLLOWING

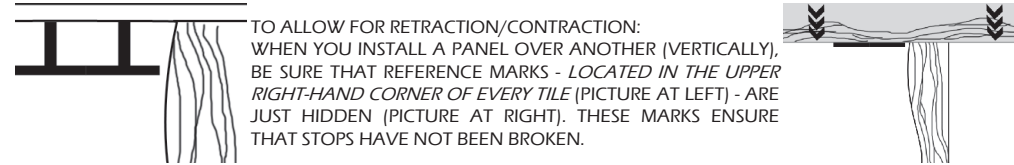

TO ALLOW FOR RETRACTION/CONTRACTION: WHEN YOU INSTALL A PANEL OVER ANOTHER (VERTICALLY), BE SURE THAT REFERENCE MARKS - LOCATED IN THE UPPER RIGHT-HAND CORNER OF EVERY TILE (PICTURE AT LEFT) - ARE JUST HIDDEN (PICTURE AT RIGHT). THESE MARKS ENSURE THAT STOPS HAVE NOT BEEN BROKEN.

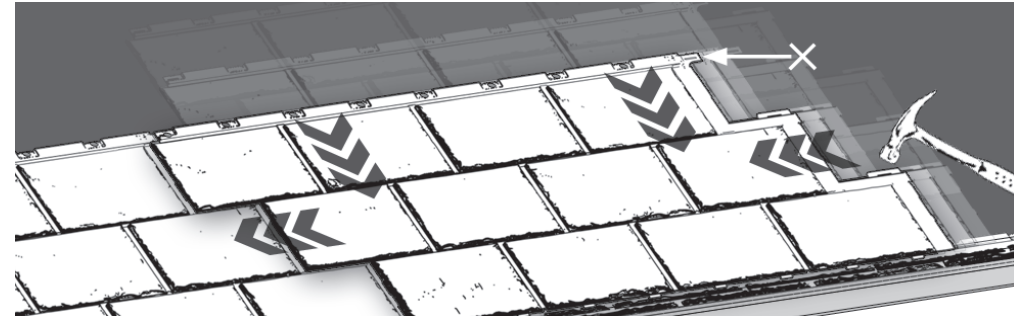

1. SLIDE THE PANEL DOWNWARDS AND DO NOT SWAT THE EXPANSION STOPS (NOTE 5 AND SEE DRAWINGS ABOVE).
2. IF INSTALLED AT OUTDOOR TEMPERATURE OVER 40° F (5° C), SLIDE THE PANEL LEFTWARDS TO THE EXPANSION STOP AND VALIDATE WITH THE TWO GUIDE LINES (NOTE 5 AND PICTURES BELOW). IF INSTALLED AT AN OUTSIDE TEMPERATURE UNDER 40° F (5° C), USE GUIDE LINE ON THE RIGHT OF NAILING HEAD (NOTE 9).
3. LINE UP THE SLATE PATTERN (BETWEEN TILES) WITH THE STARTER STRIP.
4. FIRST NAIL THE **CENTER** HOLE IN THE PANEL.
5. NEXT NAIL THE OTHER HOLES - BUT NOT THE LAST OBLONG HOLE (NOTE 3).

EXPANSION STOPS (2)

GUIDE LINES(2)

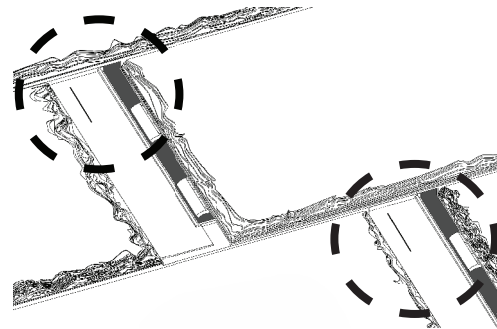
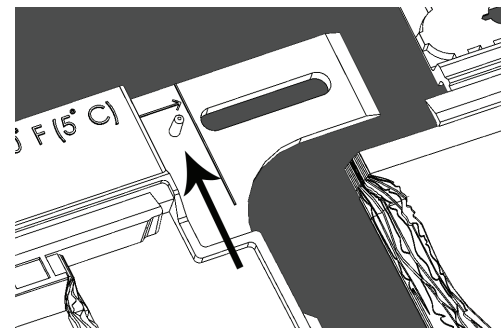

****IMPORTANT****

THE PANEL WAS DESIGNED TO AUTOMATICALLY BLOCK WHEN OUTDOOR TEMPERATURE AT TIME OF INSTALLATION IS ABOVE 40°F (5°C). BE SURE TO USE THE TWO GUIDE LINES TO ENSURE PROPER POSITIONING OF SIDE PANEL.

HOW TO FINISH A ROW

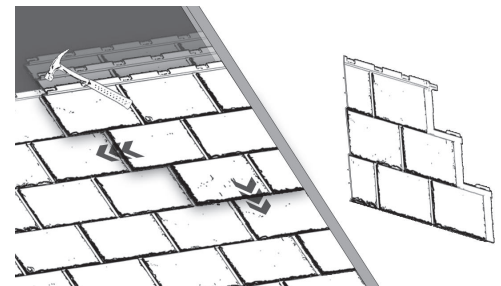

1. TEMPORARILY PLACE THE PANEL IN THE FINAL INSTALLED POSITION ABOVE THE FLASHING CUT THE PANEL 1 1/4" (3,18cm) FROM THE BOTTOM OF THE FLASHING.
2. SLIDE THE PANEL UNDER THE UNIVERSAL CHANNEL AND THEN DOWNWARDS UNTIL IT ENGAGES WITH THE LOWER PANELS (NOTE 5).
3. SLIDE THE PANEL TO THE LEFT UNTIL IT ENGAGES WITH THE PREVIOUS PANEL.
4. BE SURE TO LINE UP THE SLATE TILE PATTERN AND POSITION THE OVERLAP FOLLOWING THE TEMPERATURE GUIDES.
5. EACH TIME YOU USE A PART OF THE NEW PANEL, MAKE A NEW 3/16" (0,48cm) DIA. **CENTRAL** HOLE IN THE MIDDLE OF THE PART AT THE SAME HEIGHT AS THE OTHER INSTALLATION HOLES. NAIL FOLLOWING THE PRECEDING INDICATIONS.

FIRST PANEL OF FOLLOWING ROWS

CUT THE FIRST PANEL OF THE FOLLOWING ROW SO AS TO OBTAIN A CHECKERBOARD EFFECT. MAKE SUR THAT THE CHECKERBOARD PATTERN IS LINED UP CORRECTLY.

FOR THE LAST ROW

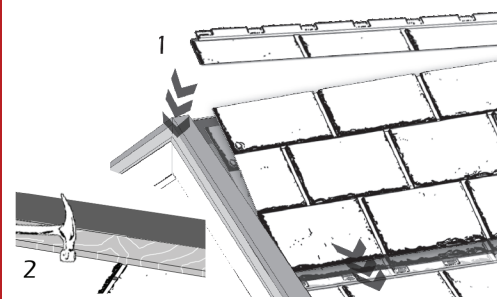

4. SLIDE THE PANEL TO THE LEFT UNTIL IT ENGAGES WITH THE PRECEDING PANEL.
5. BE SURE TO LINE UP THE SLATE TILE PATTERN AND ADJUST TILE USING THE TEMPERATURE GUIDES.
6. NAIL THROUGH EACH SLOT AND **ADD** A SET NAIL IN THE **CENTER** OF THE PANEL (NOTE 3).

STEP 5 NAILING STRIP
RIDGE CAPPING / HIP

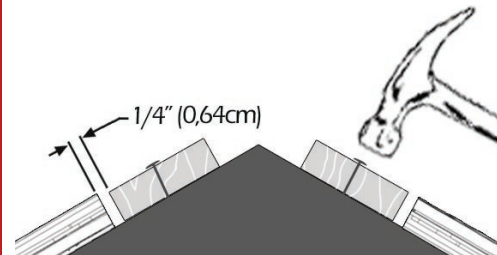

SET THE RIDGE CAP AND HIP NAILING STRIPS (0.75" (1,91cm) X 2 1/2" (6,35cm) FURRING STRIPS) 1/4" (0,64cm) FROM PANEL.

STEP 6 RIDGE CAP SHINGLE (FOR RIDGE CAP AND HIP)

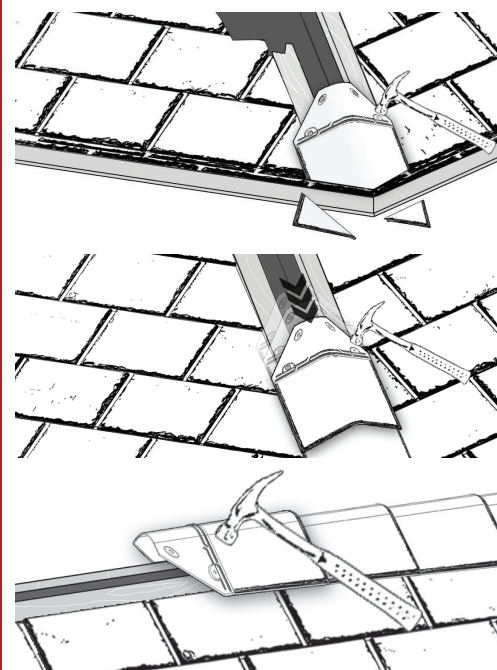

1. CUT AND ADJUST THE RIDGE CAP SHINGLE USING THE PATTERNS OF THE TWO ADJACENT STARTER STRIPS PREVIOUSLY INSTALLED.
2. NAIL THE RIDGE CAP PARTS THROUGH THE 4 RAISED OVALS (MOULDED INTO THE PART) TO THE NAILING STRIPS.
3. SET THE RIDGE CAP SHINGLES FOLLOWING THE PREVIOUS ONE AND OVERLAPPING IT BY 3/8" (0,95cm) FROM THE BEGINING OF THE PATTERN.

LAST RIDGE CAP SHINGLE: CUT A RIDGE CAP PART AT THE SPOT WHERE THE TEXTURE ENDS. TURN THE RIDGE CAP PART TO FACE THE PART PREVIOUSLY INSTALLED AND NAIL IT DOWN.

SPECIAL CASES

1. RIDGE CAP AIR VENT (OPTIONAL)

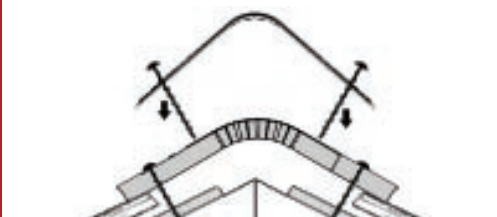

1. INSTALL PANELS.
2. SCREW THE RIDGE AIR VENT ON BEFORE AFFIXING THE RIDGE CAP SHINGLE PARTS.
3. DO NOT INSTALL THE NAILING STRIP UNDER THE ROOF AIR VENT.

2. RIDGE CAP/HIP (TRANSVERSE RIDGE TILE)

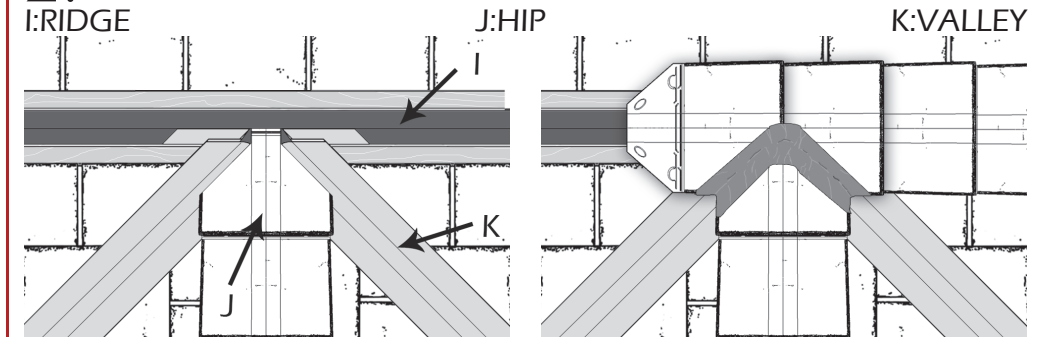

1. PLACE RIDGE CAP SHINGLE ON TRANSVERSE RIDGE.
2. CUT THE LAST RIDGE CAP SHINGLE FOLLOWING THE SIDE OF THE VALLEY CHANNEL.
3. SET THE RIDGE CAP SHINGLE ON ROOF RIDGE.
4. CUT THE 2 PARTS OF THE RIDGE SHINGLE THAT GO UP TO AND MEET THE OTHER LINE OF THE ROOF RIDGE.
5. THEN APPLY APPROPRIATE SEALANT ON PART OF RIDGE REMAINING UNCOVERED.

3. FOR A SLOPE WITH DIFFERENT SECTIONS

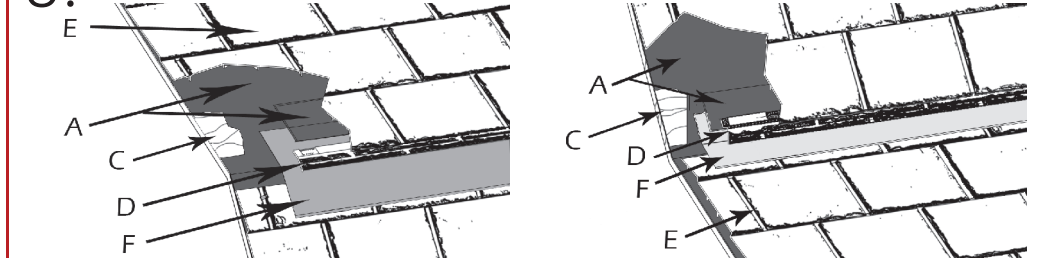

1. BE SURE THAT THE MEMBRANE COVERS THE LOWER AND THE UPPER PART OF THE ROOF.(NOTE 6 AND 7)
2. INSTALL THE PANELS IN THE LOWER PART OF THE ROOF.
3. INSTALL THE V-SHAPED FLASHING SO THAT THE BOTTOM OF THE FLASHING IS OVER THE PANELS OF THE LOWER PART AND THEN EXTEND THE MEMBRANE OF THE UPPER PART OF THE ROOF ONTO THE V-SHAPED FLASHING (OVERLAP OF 3" (7,62cm)).
4. INSTALL THE STARTER STRIPS AND THE PANELS ON THE TOP OF THE ROOF.

4. SNOW GUARDS

IMPORTANT: IT IS STRONGLY RECOMMENDED TO INSTALL SNOW GUARDS IN APPROPRIATE PLACES (NOTE 12).

DURING THE INSTALLATION OF PANELS (COPPER SNOW GUARDS)

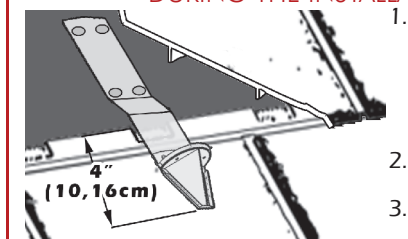

1. SEE MUNICIPAL NORMS BEFORE INSTALLATION. DETAILS REGARDING QUANTITY AND LOCATION OF THE SNOW GUARDS REMAIN THE RESPONSIBILITY OF THE INSTALLER AND CUSTOMER (NOTE 12). FOR ADDITIONAL INFORMATION PLEASE CONTACT YOUR SNOWGUARD RETAILER.
2. INSTALL THE SNOW GUARDS OPPOSITE THE HOLES AT THE TOP OF THE PANELS.
3. LEAVE AN EXPOSURE DISTANCE OF 4" (10,16cm) FROM THE NAILING STRIP.
4. SLIDE THE PANEL DOWNWARDS AND MAKE SURE YOU DO NOT BREAK THE EXPANSION STOPPERS (NOTE 5 AND SEE DRAWING ABOVE).
5. BE SURE NOT TO MISS ANY HOOKS.

INSTALLATION OVER EXISTING PANELS (STAINLESS STEEL SNOW GUARDS)

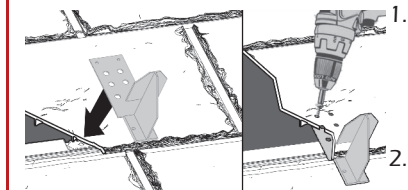

1. SEE MUNICIPAL NORMS BEFORE INSTALLATION. DETAILS REGARDING QUANTITY AND LOCATION OF THE SNOW GUARDS REMAIN THE RESPONSIBILITY OF THE INSTALLER AND CUSTOMER (NOTE 12). FOR ADDITIONAL INFORMATION PLEASE CONTACT YOUR SNOWGUARD RETAILER.
2. TEMPORARILY POSITION THE SNOW GUARD OVER THE BOTTOM OF THE SECOND ROW; MAKE SURE IT IS POSITIONNED ABOVE A NAILING HOLE OF THE INFERIOR PANEL.
3. DRILL NEW HOLES THROUGH THE NAILING HOLES OF THE SNOW GUARD.
4. SLIDE THE SNOW GUARD UNDER THE PANEL AND ALIGN NAILING HOLES WITH THE DRILLED HOLES.
5. SCREW THE SNOW GUARD THROUGH THE DRILLED HOLES SO THAT THE SCREWS PENETRATE AT LEAST 3/4"(1,91cm) INTO THE SOLID SURFACE OF THE ROOF AND SCREW HEADS ARE COMPLETELY UNDER THE PANEL. A MINIMUM OF 4 SCREWS IS REQUIRED.
6. IF DESIRED, SEAL THE DRILLED HOLES WITH AN EXTERIOR SEALANT.