

## Clay tile system

## Installation guide summary

**IMPORTANT: FOLLOW STEPS CONTAINED IN THE PRESENT GUIDE FOR WARRANTY TO BE HONOURED.**

### \* IMPORTANT

- NOTE 1 DURING INSTALLATION OF NOVIK CLAY TILE ROOFING SYSTEM, IT IS STRONGLY ADVISED TO USE ONLY RECOMMENDED MATERIALS AND/OR TOOLS. APPROPRIATE SAFETY MEASURES SHOULD BE APPLIED TO PREVENT INCIDENTS THAT MAY CAUSE INJURIES FOR WHICH MANUFACTURER SHALL NOT BE HELD LIABLE.
- NOTE 2 **TILE IS NOT IMPERMEABLE. IMPERMEABILITY (WATERPROOFNESS) IS ENSURED BY THE MEMBRANE** (IT IS IMPORTANT TO FOLLOW ALL INSTRUCTIONS OF MEMBRANE MANUFACTURER). IN CASE OF WATER INFILTRATION UNDER PANELS, TILES ARE DESIGNED TO PERMIT WATER TO DRAIN OFF.
- NOTE 3 WHEN NAILING THE PARTS, **LEAVE 1/32" (0,08cm) SPACE** BETWEEN THE HEAD OF THE NAIL AND THE PART. NAIL THE LAST UPPER HOLE ONLY AFTER HAVING OVERLAPPED THE PART FOLLOWING IT. IN ABSENCE OF NAILING HOLE, AT A CONCEALED SPOT, DRILL A NEW HOLE OF 3/16" (0,48cm) OF DIAMETER FOR NAILING.
- NOTE 4 **LEAVE A 1/4" (0,64cm) SPACE** BETWEEN THE PANEL AND THE INSIDE WALL OF THE UNIVERSAL CHANNEL, TO ALLOW FOR EXPANSION AND CONTRACTION OF THE PART.
- NOTE 5A DURING VERTICAL ASSEMBLY OF PANELS, ENSURE THAT HOOKS ARE SECURELY ENGAGED.
- NOTE 5B HORIZONTAL ASSEMBLY: ENSURE PROPER OVERLAP OF RUN-OFF CHANNELS BETWEEN PANELS.
- NOTE 6 **USE WATERPROOF, SELF-SEALING / SELF-ADHERING / SELF-HEALING MEMBRANE (MEETING THE 1970 ATSM STANDARD) OVER ENTIRE SURFACE OF ROOF. THE MEMBRANE USED MUST MEET THE REQUIRED CHARACTERISTICS OR WARRANTY IS NULL AND VOID.**
- NOTE 7 INSTALL THE MEMBRANE FOLLOWING MANUFACTURER'S SPECIFICATIONS.
- NOTE 8 USE 1-1/4" (3,2cm) HOT GALVANIZED ROOFING NAILS WITH A HEAD OF 0.4"(1cm) IN DIAMETER AND A BODY OF 0.150"(0,38cm) OF DIAMETER.
- NOTE 9 USE STANDARD MEMBRANE GLUE TO GLUE IT TO FLASHINGS STRIPS.
- NOTE 10 THE INSTALLATION MUST BE DONE ON A ROOF WITH A **MINIMUM PITCH OF 3 : 12.**
- NOTE 11 KEEP PRECISELY THE R-E-L NUMBER OF YOUR PRODUCTS (EX: REL-123456) FOR FUTURE REFERENCES.
- NOTE 12 WARNING, SNOW AND ICE WILL NOT STICK ONTO NOVIK CLAY TILE ROOFING SYSTEM. **IT IS STRONGLY RECOMMENDED TO INSTALL SNOW GUARDS WHERE SNOW AND / OR ICE FALL COULD CAUSE INJURIES AND / OR DAMAGES**

## STEP 1 WATERPROOF MEMBRANE

SELF-SEALING / SELF-ADHERING / SELF-HEALING / CLASS C FIRE RESISTANCE

WATERPROOFING THE ROOF IS ENSURED BY THE MEMBRANE (E.G. CHIMNEY, PIPING, ETC.) THE MEMBRANE MUST BE INSTAL ACCORDING TO THE MANUFACTURER'S INSTRUCTIONS.

THE MEMBRANE ENSURES WATERPROOFNESS OF ROOF.

## STEP 2 UNIVERSAL CLAY MOULDING

DETAILS / DIMENSIONS / INSTALLATION

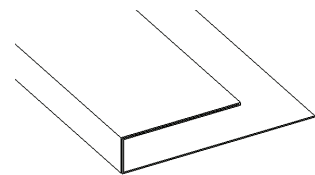

### LOW CHANNEL

MATERIAL: ALUMINUM  
THICKNESS: 0.0185" (0,047cm)  
DIMENSIONS: 0.75" (1,91cm) X 1.125" (2,86cm) X 2.44" (6,19cm)  
LENGTH: 9.84' (3m)

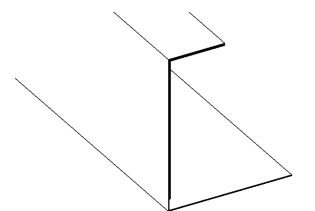

### HIGH CHANNEL

MATERIAL: ALUMINUM  
THICKNESS: 0.0185" (0,047cm)  
DIMENSIONS: 1.25" (3,18cm) X 3.44" (8,73cm) X 2.81" (7,14cm)  
LENGTH: 9.84' (3m)

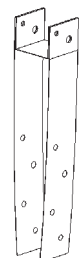

### RIDGE RISER

MATERIAL: ALUMINUM  
THICKNESS: 0.0185" (0,047cm)  
DIMENSIONS: 9.00" (22,86cm) X 1.75" (4,45cm) X 1.00" (2,54cm)

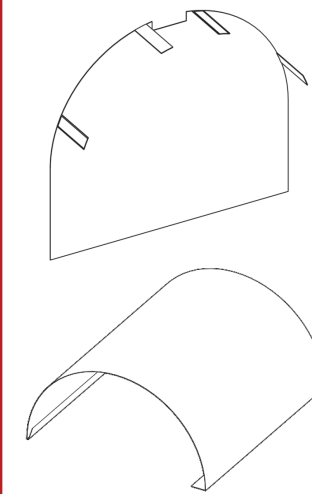

### RIDGE END CAP

MATERIAL: ALUMINUM  
THICKNESS: 0.0185" (0,047cm)  
DIMENSIONS: 10.44" (26,51cm) X 9.13" (23,18cm)

### RIDGE JUNCTION

MATERIAL: ALUMINUM  
THICKNESS: 0.0185" (0,047cm)  
DIMENSIONS: 16.44" (41,75cm) X 12" (30,48cm) X 0.625" (1,59cm)

## A INSTALLING RIDGE AND HIP RISERS

A RIDGE AND HIP NAILING SUPPORT

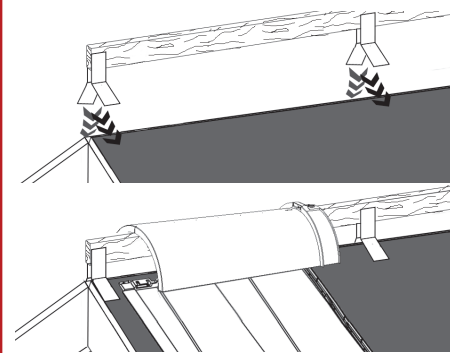

- ADJUST HEIGHT OF RIDGE ACCORDING TO SLOPE OF ROOF. CHECK HEIGHT WITH ONE PANEL AND ONE RIDGE TILE TEMPORARILY INSTALLED.
- NAIL THE RIDGE RISERS ONTO THE ROOF (3 PER 8 FEET (EVERY 4 FEET)).
- NAIL DOWN NAILING STRIPS (2" X 4") ONTO RISERS. ALL RIDGES AND HIPS MUST HAVE A NAILING STRIP ON TOP OF THEM.

## B INSTALLING FLASHING ON SLOPE

LOW / HIGH CLAY CHANNELS

A: MEMBRANE  
B: DRIP EDGE FLASHING  
C: PLYWOOD  
D: UNIVERSAL CLAY MOULDING  
E: NOVIK ROOFING  
F: STANDARD « V-SHAPED » METAL FLASHING  
G: STANDARD « L-SHAPED » METAL FLASHING  
H: WALL

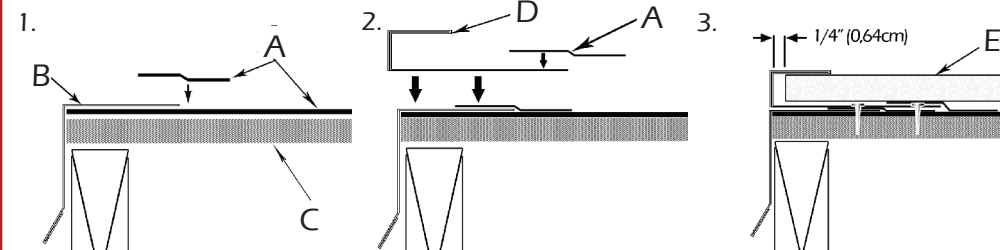

- INSTALL THE RECOMMENDED MEMBRANE (NOTES 6-7). INSTALL DRIP EDGE FLASHINGS AND COVER THE END OF THE DRIP EDGE WITH ANOTHER STRIP OF MEMBRANE (NOTE 8).
- THEN INSTALL THE APPROPRIATE CLAY CHANNELS AND COVER THE END OF THE CHANNEL WITH A STRIP OF MEMBRANE (NOTE 8).
- THE CLAY TILE SYSTEM IS SLID INTO THE CHANNELS IN STEPS 3 AND 4 (NOTE 4).

## C INSTALLING VALLEY CHANNEL FLASHING

CLAY MOULDING

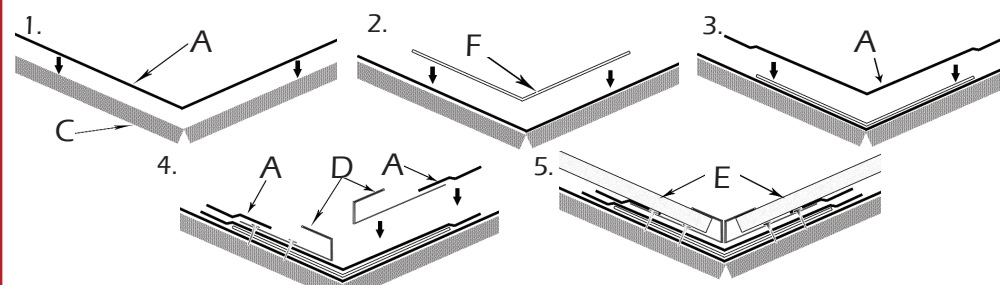

- INSTALL THE RECOMMENDED MEMBRANE (NOTES 6-7). INSTALL DRIP EDGE FLASHINGS AND COVER THE END OF THE DRIP EDGE WITH ANOTHER STRIP OF MEMBRANE (NOTE 8).
- INSTALL STANDARD V-SHAPED METAL FLASHING (NOTE 8).
- COVER THE V-SHAPED FLASHING WITH A MEMBRANE STRIP (NOTE 8).
- THEN INSTALL THE HIGH CLAY CHANNELS AND COVER THE END OF CHANNELS WITH A STRIP OF MEMBRANE (NOTE 8).
- THE CLAY TILE SYSTEM IS SLID INTO THE CHANNELS IN STEPS 3 AND 4 (NOTE 4).

## D INSTALLING PARAPET FLASHING

LOW / HIGH CLAY CHANNELS

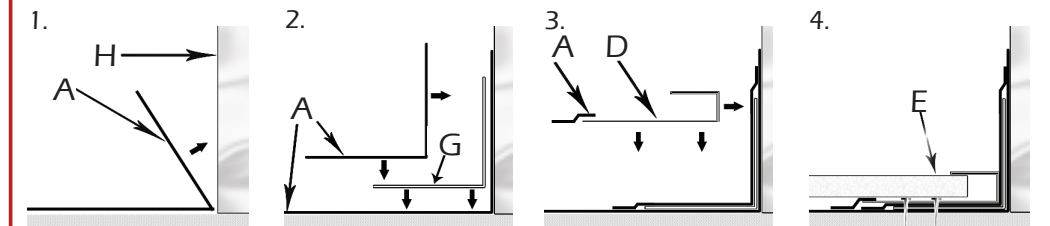

- INSTALL THE RECOMMENDED MEMBRANE (NOTE 6 AND 7).
- INSTALL STANDARD L-SHAPED FLASHING AND COVER THE L-SHAPED FLASHING WITH MEMBRANE STRIP (NOTE 8).
- THEN INSTALL THE APPROPRIATE CLAY CHANNELS AND COVER THE END OF THE CHANNEL WITH A STRIP OF MEMBRANE (NOTE 8).
- THE CLAY TILE SYSTEM IS SLID INTO THE CHANNELS IN STEPS 3 AND 4 (NOTE 4).

## STEP 3 INSTALLING STARTER STRIPS

INSTALLING CLAY SYSTEM

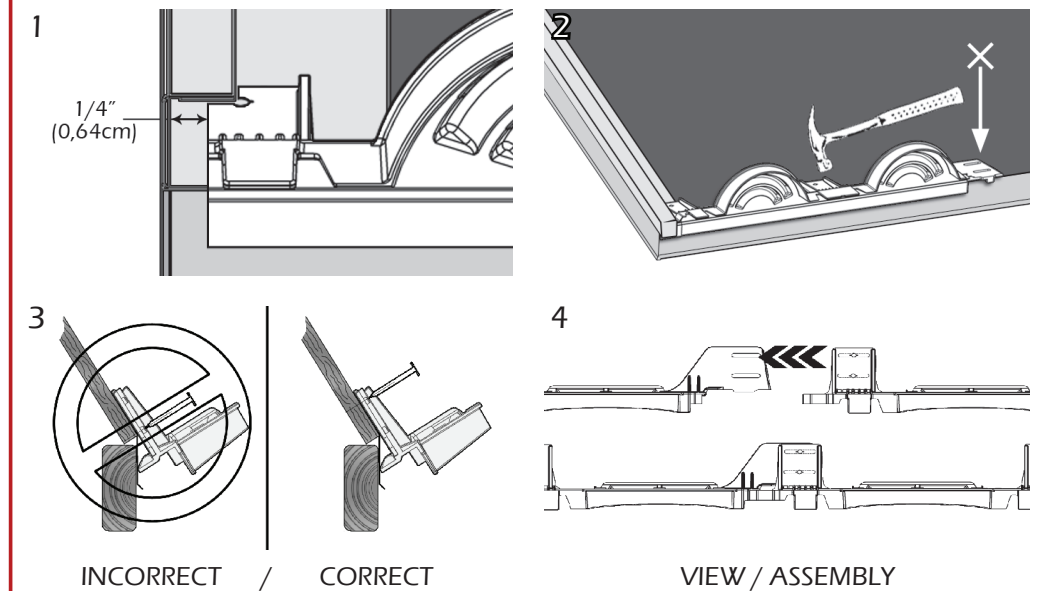

- INSTALL THE FIRST STARTER STRIP AT 1/4" (0.64cm) FROM BOTTOM OF THE CHANNEL AND UNTIL THE POSITIONING STOPS (ON REVERSE SIDE) ARE RESTING ON THE EDGE OF THE ROOF.
- NAIL THE STARTER STRIP DOWN, EXCEPT FOR THE LAST HOLE. FOR A MAXIMUM STRENGTH, IT IS RECOMMENDED TO NAIL BOTH ROWS OF NAILING HOLES (NOTE 3).
- FOR HIGH SLOPE ROOF, NAIL DOWN INTO UPPER NAILING HOLES OF THE STARTER STRIP.
- OVERLAP THE NAILING HOLES OF THE NEXT STARTER STRIP OVER THE PRECEDING AND NAIL IT DOWN (NOTE 3).
- REPEAT UP TO END OF ROOF.

## Clay tile system

## Installation guide summary

**IMPORTANT: FOLLOW STEPS CONTAINED IN THE PRESENT GUIDE FOR WARRANTY TO BE HONOURED.**

### STEP 4 INSTALLING PANELS INSTALLING CLAY SYSTEM

#### FIRST PANEL

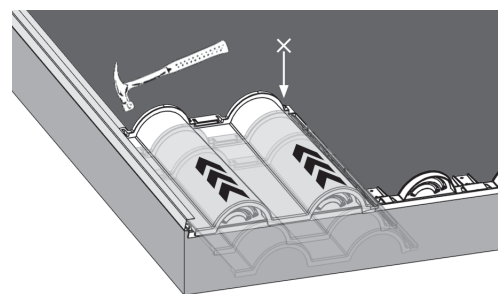

1. INSERT FIRST PANEL INTO CHANNEL (NOTE 4).
2. POSITION THE PANEL ON THE STARTER STRIP AND PUSH UPWARDS TO ENGAGE HOOKS. ENSURE HOOKS ARE SECURELY ENGAGED
3. NAIL THROUGH SET HOLES, **EXCEPT FOR LAST HOLE** (NOTE 3).

#### PANELS FOLLOWING

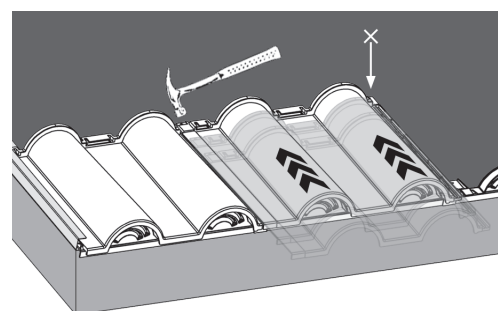

1. INSERT THE NEXT PANEL ON THE STARTER STRIP FOLLOWING.
2. ENSURE PANEL OVERLAPS THE GUTTER CHANNEL OF THE PREVIOUS PANEL.
3. PUSH UPWARDS TO ENGAGE HOOKS. ENSURE SECURE ENGAGEMENT OF HOOKS AND PROPER OVERLAP OF PANELS.
4. NAIL THROUGH SET HOLES, **EXCEPT FOR LAST HOLE** (NOTE 3).

#### HOW TO FINISH A ROW

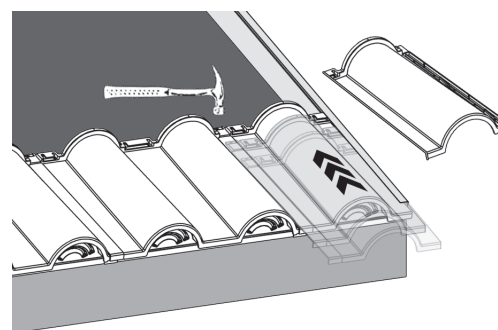

1. TEMPORARILY SET THE PANEL IN ITS FINAL INSTALLED POSITION ON THE CHANNEL. CUT THE PANEL 1/4" (0,64cm) FROM THE BOTTOM OF THE CHANNEL.
2. INSERT THE PANEL INTO THE CHANNEL (NOTE 4).
3. POSITION THE PANEL ON THE STARTER STRIP AND PUSH UPWARDS TO ENGAGE THE HOOKS. ENSURE SECURE ENGAGEMENT OF HOOKS.
4. ENSURE CORRECT OVERLAP OF PANELS.
5. NAIL THROUGH ALL THE SET HOLES (NOTE 3).

#### FIRST PANEL OF FOLLOWING ROWS

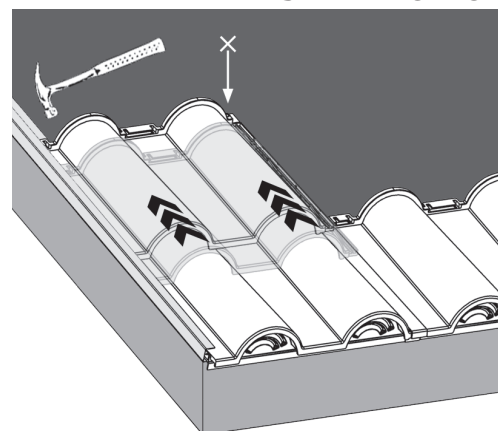

1. INSERT PANEL INTO THE CHANNEL (NOTE 4).
2. POSITION THE PANELS OVER BARRELS OF LOWER PANEL.
3. PUSH UPWARDS TO ENGAGE HOOKS.
4. NAIL THROUGH SET HOLES, **EXCEPT FOR LAST HOLE** (NOTE 3).

#### FOR LAST ROW

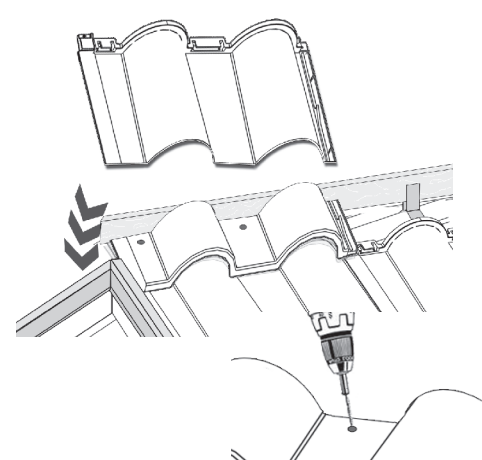

1. CUT PANELS OF LAST ROW ALONG RIDGE AIR OPENING (1/4" (0,64cm) FROM NAILING STRIP IF UNVENTED).
2. CREATE A NAILING AREA BY DRILLING 1/4" (0,64cm) DIAMETRE HOLES BETWEEN EACH BARREL, 3/4" (1,91cm) FROM THE PANEL CUT-OFF.
3. POSITION THE PANEL OVER THE BARRELS OF THE LOWER PANEL AND PUSH UPWARDS TO ENGAGE HOOKS.
4. NAIL THROUGH ALL THE NEW HOLES IN THE PANEL (NOTE 3).

### STEP 5 INSTALLING RIDGE AND HIP TILE (HIP)

#### FIRST HIP TILE

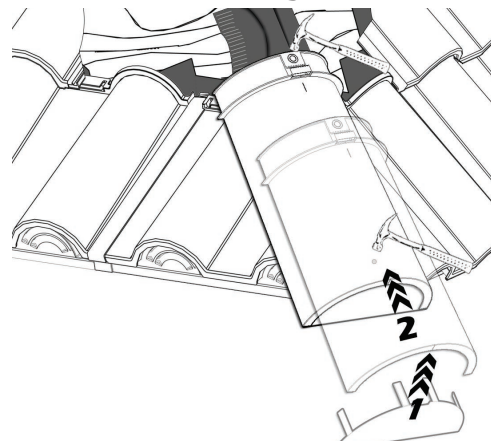

1. SPREAD RIDGE AND HIP MEMBRANE OVER NAILING STRIPS, ALONG THE HIP.
2. **FOR FIRST TILE ONLY**, INSTALL RIDGE AND HIP END CAP PIECE.
3. NEXT INSTALL ASSEMBLY ON NAILING STRIP SO AS TO COVER STARTER STRIPS.
4. **FOR FIRST TILE ONLY**, NAIL THE LOWER EDGE, THEN NAIL IN THE NAILING AREA.

#### NEXT HIP TILES

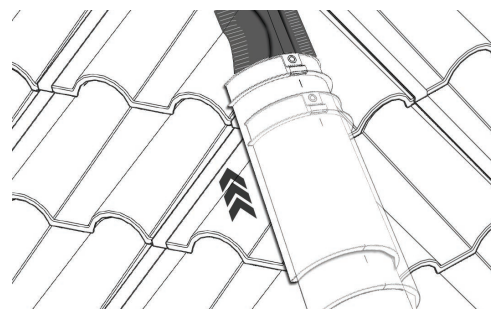

1. POSITION ANOTHER TILE OVER THE PREVIOUS ONE.
2. PUSH UPWARDS TO ENGAGE THE HOOKS.
3. LINE UP THE VISUAL GUIDES CORRECTLY FOR NEAT ASSEMBLY.
4. NAIL DOWN IN NAILING AREA.
5. IN VERY WINDY AREAS, NAIL DOWN BOTH ENDS, AS WITH FIRST HIP TILE.

#### HOW TO FINISH A HIP

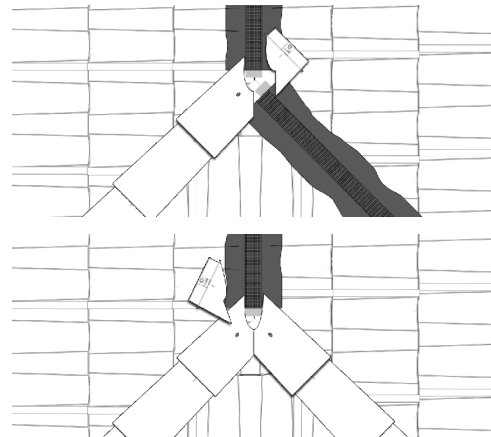

1. ADJUST AND CUT THE LAST TILE ALONG THE ROOF ANGLES.
2. NAIL DOWN THE LAST TILE 3/4" (1,91cm) FROM THE TILE CUT-OFF.

1. ASSEMBLE THE SECOND HIP SECTION.
2. ADJUST AND CUT THE LAST TILE ALONG THE ROOF ANGLES.
3. NAIL DOWN THE LAST TILE 3/4" (1,91cm) FROM THE TILE CUT-OFF.

### STEP 6 INSTALLING RIDGE AND HIP TILE (RIDGE)

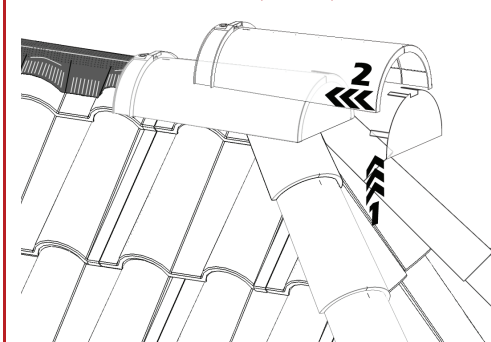

1. SPREAD RIDGE AND HIP MEMBRANE OVER NAILING STRIPS ALONG RIDGE.
2. **FOR FIRST TILE ONLY**, INSTALL RIDGE AND HIP END CAP PIECE.
3. NEXT INSTALL ASSEMBLY ON NAILING STRIP SO AS TO COVER THE TWO LAST HIP TILES.
4. **FOR FIRST TILE ONLY**, NAIL IN THE NAILING AREA AND THE OPPOSITE EDGE.
5. INSTALL ANOTHER TILE ON THE PREVIOUS ONE ENSURING THAT THE HOOKS ARE SECURELY ENGAGED AND THAT THE ASSEMBLY IS IN A STRAIGHT LINE BEFORE NAILING IN THE NAILING AREA.
6. **START ASSEMBLING FROM BOTH ENDS TO MEET IN THE CENTRE OF ROOF RIDGE.**

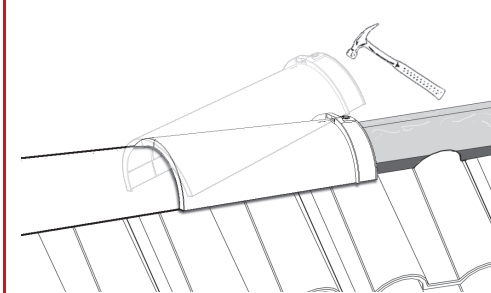

### STEP 7 INSTALLING RIDGE JUNCTION (RIDGE)

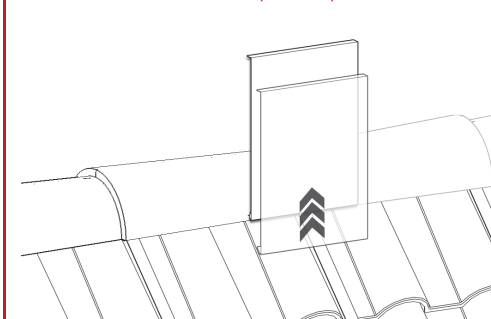

1. CUT TILES TO CENTER OF ROOF RIDGE.
2. APPLY A BEAD OF CAULKING TO THE JOINT OF THE RIDGE TILES.
3. CENTERING THE RIDGE JUNCTION.
4. INSERT ONE PRE-BENT HOOKS OF THE RIDGE JUNCTION UNDER THE RIDGE TILES
5. WRAP THE RIDGE JUNCTION FOLLOWING CURVE OF THE TILES.
6. INSERT THE SECOND PRE-BENT HOOK UNDER THE OTHER SIDE OF THE TILES AND **REBEND THE RIDGE JUNCTION CORRECTLY UNDER THE RIDGE TILES.**

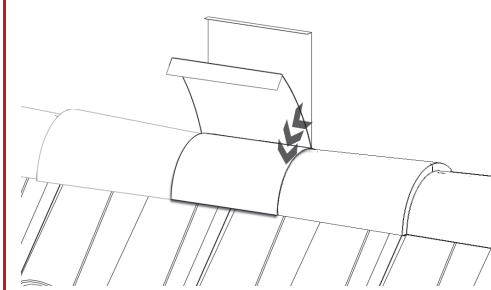

**IMPORTANT: IN THE EVENT THAT RIDGE PIECES ARE COMPLETE WHEN THEY MEET, CUT THE EDGE OF THE UPPER HOOKS ON 2,25" (5,72cm) BEFORE APPLYING THE RIDGE JUNCTION.**

### STEP 8 SNOW GUARDS (STAINLESS STEEL)

**IMPORTANT: IT IS STRONGLY RECOMMENDED TO INSTALL SNOW GUARDS IN APPROPRIATE PLACES (NOTE 12).**

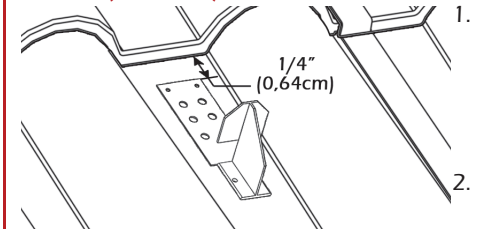

1. SEE MUNICIPAL NORMS BEFORE INSTALLATION. DETAILS REGARDING QUANTITY AND LOCATION OF THE SNOW GUARDS REMAIN THE RESPONSIBILITY OF THE INSTALLER AND CUSTOMER (NOTE 12). FOR ADDITIONAL INFORMATION PLEASE CONTACT YOUR SNOWGUARD RETAILER.
2. SNOW GUARDS MUST BE INSTALLED ON FLAT SURFACES OF PANELS AT 0,25" (0,64cm) FROM THE BOTTOM OF UPPER PANELS.
3. POSITION THE SNOW GUARD AND DRILL NEW HOLES INTO THE PANEL THROUGH THE NAILING HOLES OF THE SNOW GUARD.
4. SCREW THE SNOW GUARD INTO THE DRILLED HOLES SO THAT THE SCREWS PENETRATE AT LEAST 3/4" (1,91cm) INTO THE SOLID SURFACE OF THE ROOF. A MINIMUM OF 4 SCREWS IS REQUIRED.